



Absolutely Authentic. Uniquely Everett.

The Port Gardner Collection includes six unique apartment buildings offering vintage charm and easy access to everything Everett. Located in Everett's desirable Port Gardner and Bayside neighborhoods, studios, one- and two-bedroom apartment homes are available today.

Why the Port Gardner Collection?

- Homes with personality* – just like you
- Skipping distance to Downtown Everett entertainment
- Easy commutes to Boeing, Naval Station Everett, Providence Medical Center and other area employers
- On-site parking, laundry and storage
- High value, low maintenance – perfect for your budget
- Attentively managed by Skotdal Real Estate

*Think tiki and some positively Seussical landscaping elements!

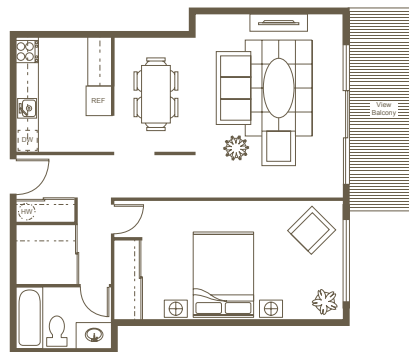

Meet the Port Gardner Collection

CASCADE VIEW
3611 Colby Avenue
Everett, WA 98201

SAN MARCO
2401 Rucker Avenue
Everett, WA 98201

GLACIER VISTA
3319 Colby Avenue
Everett, WA 98201

VALHALLA
3201 Rockefeller Avenue
Everett, WA 98201

OLYMPIAN
2231 Rucker Avenue
Everett, WA 98201

WESTWOOD
3213 Wetmore Avenue
Everett, WA 98201

Now Leasing

Think you've met your match in the Port Gardner Collection? Contact us today to schedule a tour and learn more.

Live@PortGardnerCollection.com

425-252-0600

PortGardnerCollection.com

The Port Gardner Collection is managed by Skotdal Real Estate – improving living options in Everett for nearly 50 years.

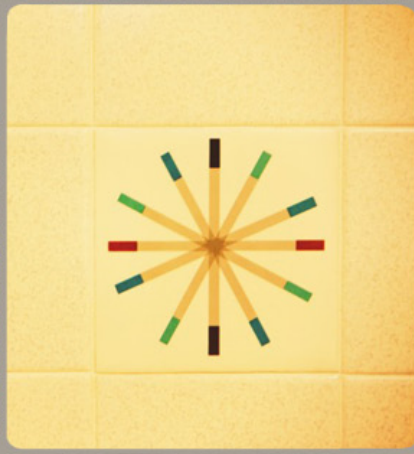

A Hop, Skip, and a Jump to Everything Everett

Located in Everett's desirable Bayside and Port Gardner neighborhoods, the Port Gardner Collection communities are all a short walk, drive, or bus ride away from friendly and fun Downtown Everett. Commuting to Boeing, Naval Station Everett, Providence Medical Center and other area employers is also quick and easy.

Visit DowntownEverett.com to explore what's in walking distance.



- 1** OLYMPIAN
2231 Rucker Avenue
- 2** SAN MARCO
2401 Rucker Avenue
- 3** VALHALLA
3201 Rockefeller Avenue
- 4** WESTWOOD
3213 Wetmore Avenue
- 5** GLACIER VISTA
3319 Colby Avenue
- 6** CASCADE VIEW
3611 Colby Avenue